

amir prestige



25 River Crescent Broadbeach Waters QLD

5 🚗 4 🚗 4 🚗

Auction In Rooms, 24th January from 11am, Langham Hotel, Surfers Paradise

Flawless craftsmanship, cutting-edge bespoke aesthetic and magnificent unobstructed Easterly water & city skyline views unite in this world class custom residence to deliver what is undoubtedly Broadbeach Waters most inspiring home, anchored on an impressive 971sqm parcel of land.

Welcome to this designer, near-new luxury family home, a masterpiece of contemporary architecture designed by the renowned award-winning architect, Jared Poole. With 817* square meters of meticulously crafted living and entertaining space spanning across two levels, this property offers an unparalleled level of modern luxury facing due North-East to water.

Price : \$ 5,300,000
Building Size : 817.57 sqm
Land Size : 971 sqm
View : <https://www.amirprestige.com.au/sale/ql-d/gold-coast/broadbeach-waters/residential/house/7851505>

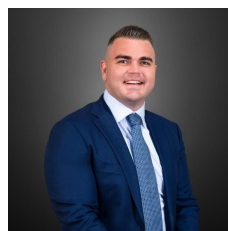

Joshua Soineva
07 5555 1600



Marc Keswell
07 5532 9996

<https://www.amirprestige.com.au>

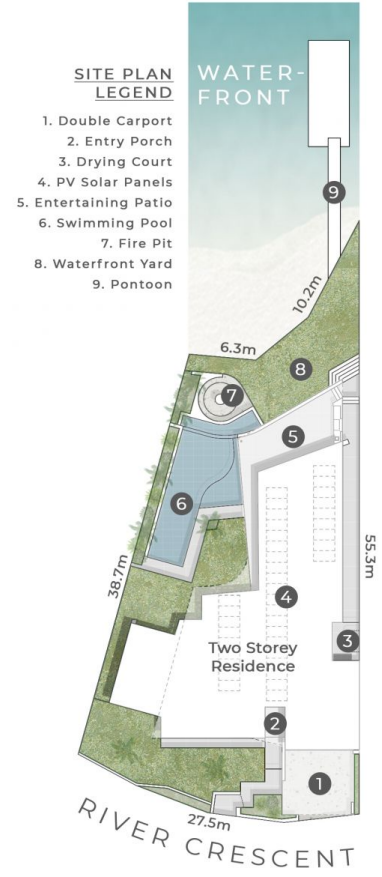
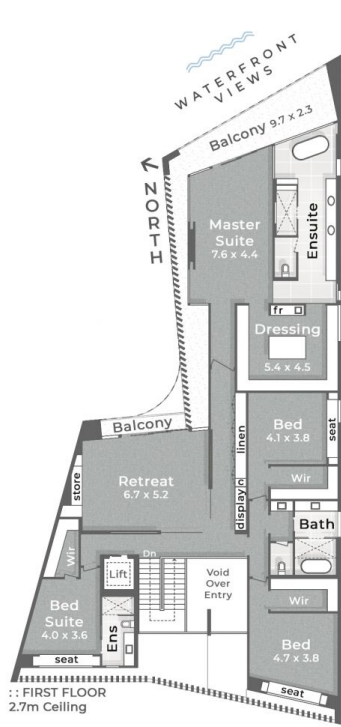

25 River Crescent BROADBEACH WATERS

971m² | 5 Bed + Media + Office | 4 Bath + Powder | 2 Car

Internal 660m² | Void 12m² | Balconies, Patio & Porch 103m² | Carport 42m² | Total 817m²

amir prestige

Joshua Soineva 0411 513 293

This is not a legal document therefore all measurements and information provided is subject to survey. No permission is given to use or alter this Floor Plan without the consent of Pure Design Concepts. The overall presentation style, layout, imagery, fonts, background, colours and terminology has been originally created by PDC and is subject to strict copyright. No ownership is taken of building design. Find out more at puredesignconcepts.com.au

pdc.