

amir prestige



15 The Promenade Isle Of Capri QLD

5 🏠 3 🚗 4 🚗

Discover an extraordinary opportunity to own a waterfront estate that redefines luxury living. This impeccably positioned property commands unrivalled views of the main river and an iconic skyline, gracing Adam's Basin in the heart of the Gold Coast's most prestigious enclave. Nestled on a substantial 696m² Main River block on the city's most sought-after street, this tightly held residence offers a once-in-a-lifetime chance to secure a blue-chip address where elegance meets endless potential.

Imagine docking your vessel at a protected mooring with serene, uninterrupted views of Girung Island? a rare privilege on The Promenade, the Gold Coast's epitome of upscale living. Whether you envision a complete rebuild to craft your ultimate dream family home or a thoughtful

Type : House
Price : Contact Agent
Land Size : 696 sqm
View : <https://www.amirprestige.com.au/sale/qld/gold-coast/isle-of-capri/residential/house/8122128>

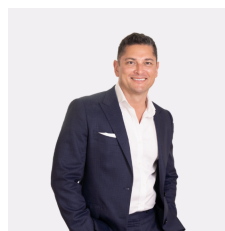

Marc Keswell
0477 000 619



Avalon Vicario
0406 113 400

[For full version visit the website](#)

<https://www.amirprestige.com.au>
Gold Coast Luxury Real Estate

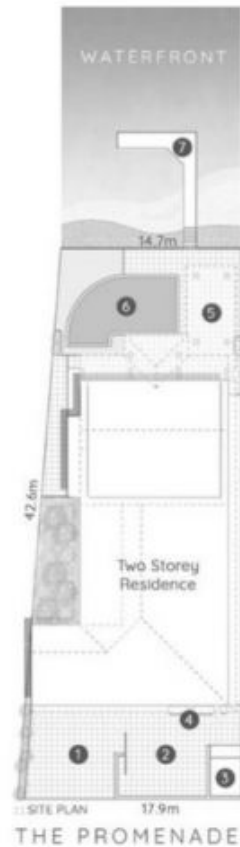

15 The Promenade ISLE OF CAPRI

- 696m²
- 4 Bed + Study
- 3 Bath
- 2 Car + Off-Street

Internal 393m²
 Patio, Balcony & Garage 90m²
Total 483m²

This is not a legal document therefore all measurements and information provided is subject to survey. No permission is given to use or alter this floor plan without the consent of Pure Design Concepts. The overall presentation style, layout, images, fonts, background, colours and branding has been originally created by PDC and is subject to strict copyright. No ownership is taken of building design. Find out more at puredesignconcepts.com.au

amir prestige